

Parts List			
ITEM	QTY	NAME	MATERIAL
1	1	311.8051	CB TUBE, 30MM
2	2	230.8009	CB ULTIMATE ADAPTER, 30MM
3	1	244.8006	CB ULTIMATE CLUTCH ASSEMBLY, 25MM, SATIN
4	1	236.8015	CB ULTIMATE SIDE BRACKET, 3-WAY, SATIN
5	2	278.8074	CB WALL FIXING PLATE, SIDE BRACKET
6	1	242.8001	CB ULTIMATE ADAPTER
7	4	278.8075	CB INSERT PLATE, SIDE BRACKET
8	1	230.8011	CB DBL ROLL ULTIMATE ADAPTER, BOTTOM RAIL
9	2	238.8002	CB ULTIMATE BOTTOM BAR END CAP
10	2	316.8002	CB ULTIMATE FASCIA, SATIN
11	1	315.9151	CB DBL INTERIOR BOTTOM BAR, SILVER

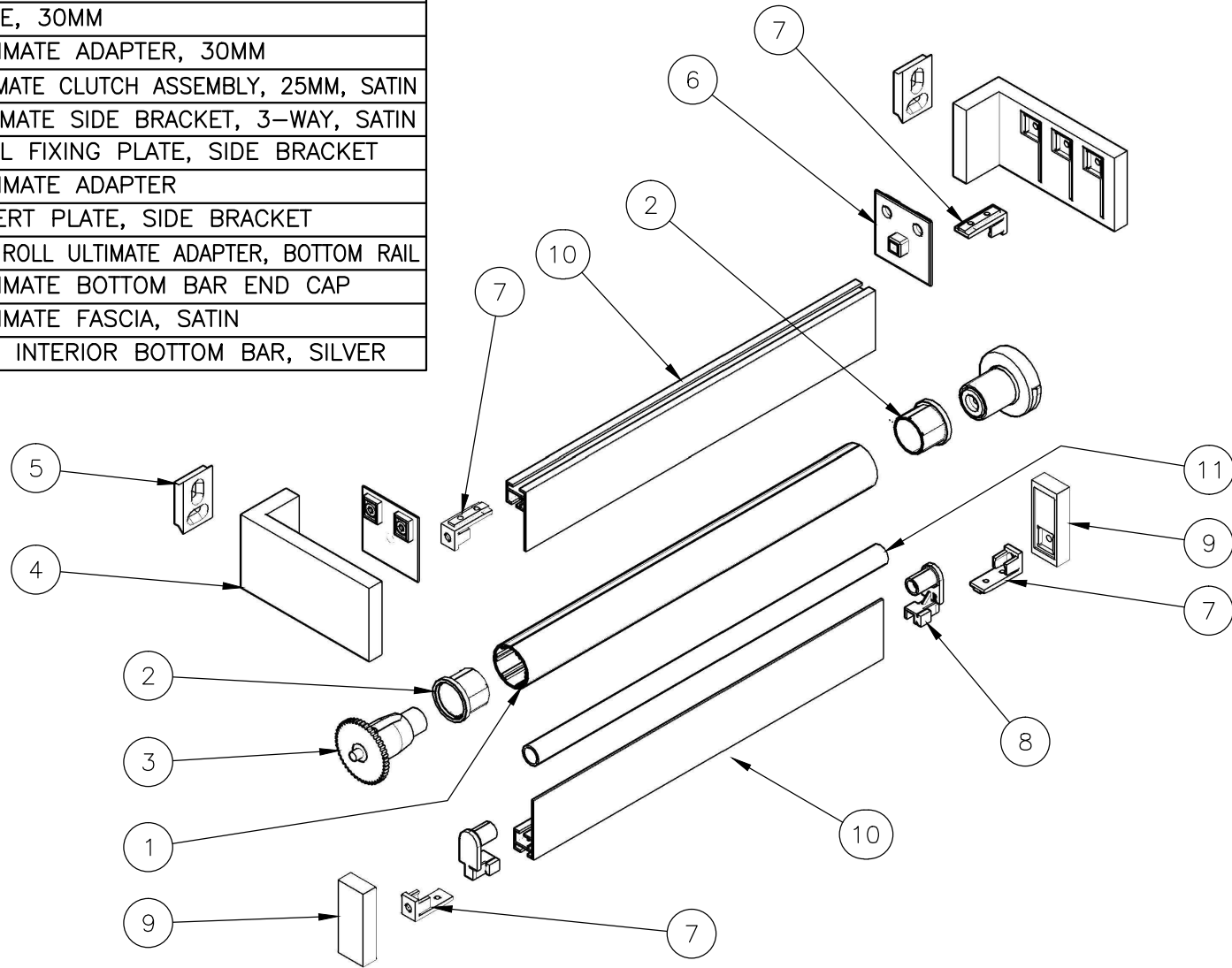

<b>CONFIDENTIAL</b> All information disclosed in this document is proprietary to BTX Window Automation. Holder agrees to maintain it in confidence and must not replicate or reveal this information in any manner.	Project	GEMINI		
	Dim	MM		
	Tolerances			
	.XX ± .015 .XXX ± .005 ANG ± .5°	Title	GEMINI MANUAL DOUBLE ROLLER SHADE	
	By: B BRYSON	Date: 5/12/2014	Scale: N/A	Sheet 1 of 3
Title GEMINI MANUAL DOUBLE ROLLER SHADE		Size	Matl:	Dwg No: 2035-U
Date: 5/12/2014		Scale: N/A	Sheet 1 of 3	Rev A
FILE: C:\ENGINEERING\ASSEMBLIES\GEMINI SHADE SYSTEMS\GEMINI S\2035-U GEMINI S R MANUAL				

