

| Parts List | | | |
|------------|-----|-------------|---------------------------------|
| ITEM | QTY | NAME | MATERIAL |
| 1 | 1 | 101.8003 | MOTOR, ABC-06-QC120 |
| 2 | 1 | 230.8004 | CB DRIVE ADAPTER, 2.0" |
| 3 | 2 | 230.8003 | CB ADAPTER, 2.0" |
| 4 | 1 | 252.8001 | CB ENDPLUG, 42MM |
| 5 | 1 | 260.8001 | CB ENDPLUG INSERT |
| 6 | 2 | 236.8006 | BRACKET, ABSOLUTE, 80MM, WHITE |
| 7 | 1 | 311.2120.NO | TUBE, 2.0" RND ALUM |
| 8 | 1 | 323.1020 | FLAT BAR 1/8 X 1 |
| 9 | 2 | 241.8002 | CB FASCIA CAP SUPPORT, 80MM |
| 10 | 1 | 316.8006 | CB ABSOLUTE FASCIA, WHITE, 80MM |

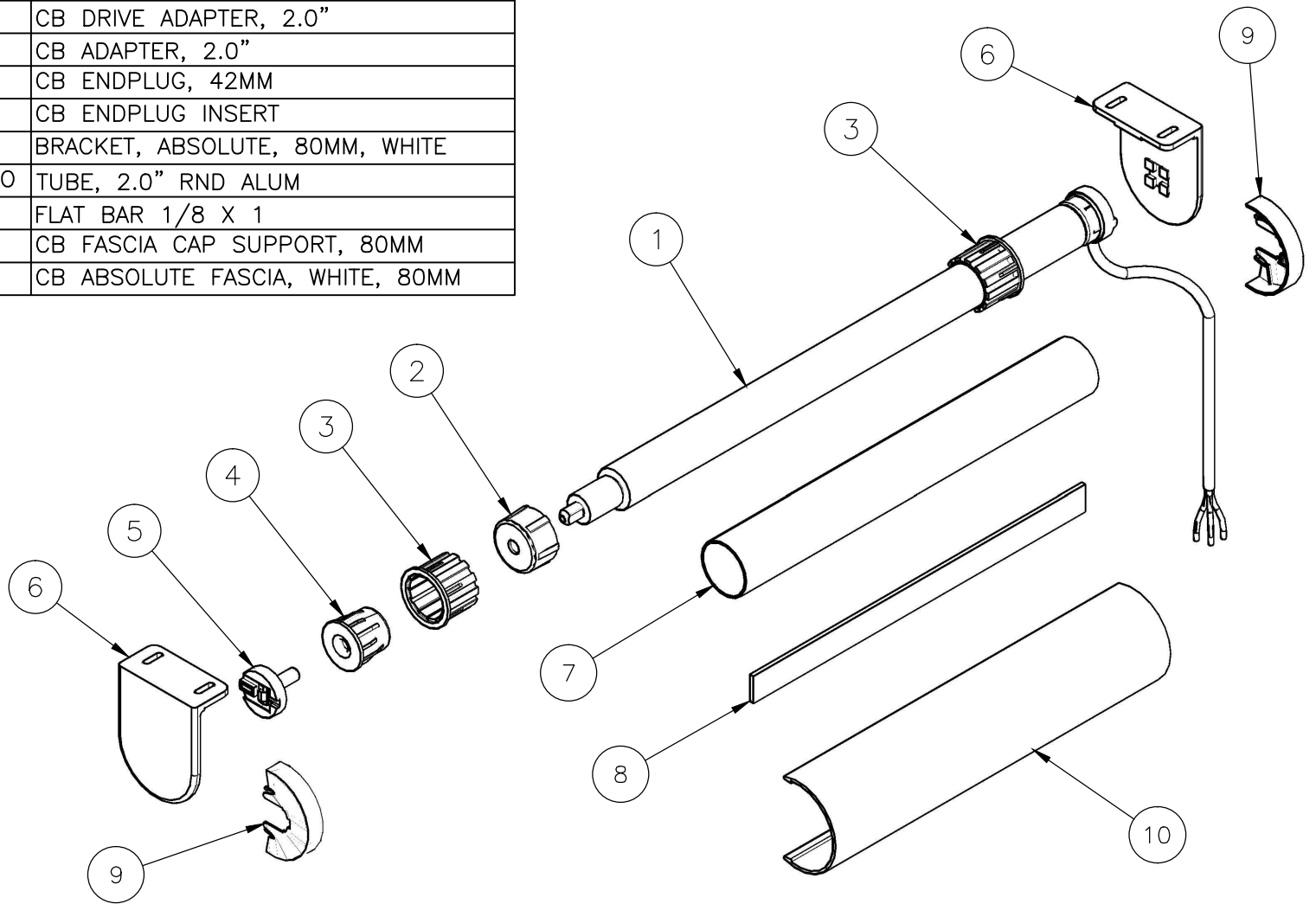

| | | | | |
|--|------------|--|------------|--------------|
| CONFIDENTIAL All information disclosed in this document is proprietary to BTX Window Automation. Holder agrees to maintain it in confidence and must not replicate or reveal this information in any manner. | Project | SORINA | | |
| | Dim | MM | | |
| | Tolerances | .XX ± .015 .XXX ± .005 ANG ± .5° | | |
| | Size | A | Matl: | |
| By: B BRYSON | | Date: 5/8/2014 | Scale: N/A | Sheet 1 of 2 |
| Title SORINA M CB MOTORIZED ROLLER SHADE | | Dwg No: | 3060-F | |
| FILE: C:\ENGINEERING\ASSEMBLIES\ROLLER SHADE SYSTEMS\MOTORIZED\SORINA M MOTORIZED\M CB MOTORIZED\3060-F SORINA M FASCIA CB MOTORIZED ROLLER SHADE | | Rev | A | |